

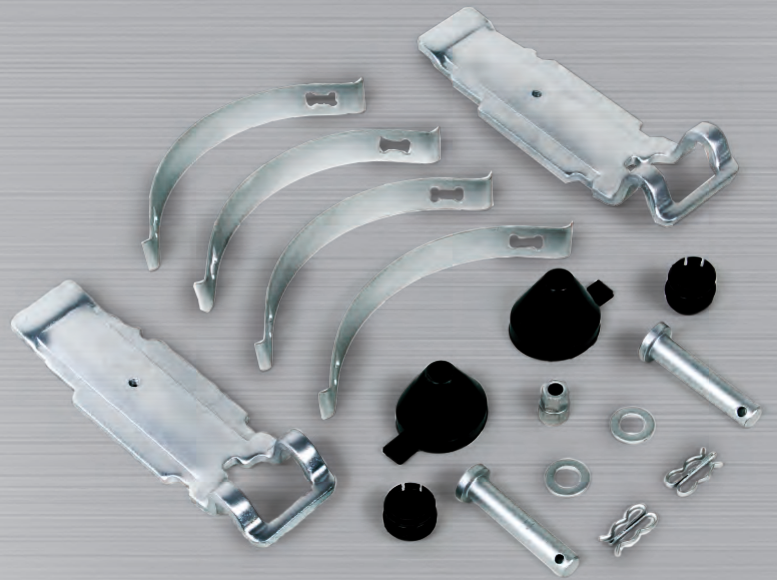

INTERNATIONAL
BRAKE INDUSTRIES, INC.

HEAVY DUTY AIR DISC BRAKE HARDWARE

for Commercial Vehicles



To learn more www.internationalbrakeindustries.com

Heavy Duty Brake Hardware

for Commercial Vehicles

Kit #
H9901

FMSI:
D1560

Brake Type & System:

- Meritor
- D-Duco

Application:

- Volvo



Kit #
H9904

FMSI:
D1407

Brake Type & System:

- Meritor
- D-Elsa1
- Elsa 225HC

Application:

- MAN
- Setra
- Van Hool



Kit #
H9902

FMSI:
D1311, D1370
D1690, D1708
D1323

Brake Type & System:

- Meritor
- EXX225H2
- EX225H3
- EX225L2

Application:

- MCI



Kit #
H9905

FMSI:
D1525, D1526

Brake Type & System:

- Meritor D-Elsa
- DX 195
- DX225

Application:

- Trailer Axles



Kit #
H9903

FMSI:
D1310

Brake Type & System:

- Meritor
- D-Elsa2

Application:

- Man
- Van Hool



Kit #
H9906

FMSI:
D1312

Brake Type & System:

- Meritor D Lisa
- 2x60

Application:

- MCI
- Neoplan
- Prevost
- Volvo

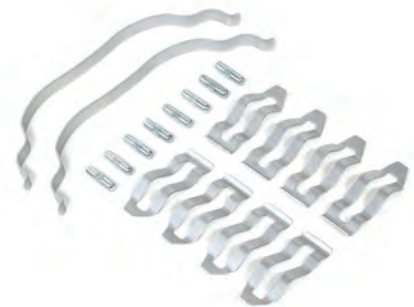

IBI Heavy Duty Brake Hardware provides a better and more complete brake job, restoring brakes to like-new performance. Doing a complete brake job with all new hardware protects your customers' investment by eliminating premature wear and prolonging the life of their new pads. It also equals less down time and keeping your customers' fleet on the road, eliminating comebacks and increasing customer satisfaction.

**Kit #
H9907**

FMSI:
D1369

**Brake Type
& System:**

- Knorr SK7
- ADB225
- ADB22X
- ADB22X-LT

Application:

- SAF Axles



**Kit #
H9910**

FMSI:
D1518

**Brake Type
& System:**

- WABCO
- PAN 17

Application:

- SAF Axles



**Kit #
H9908**

FMSI:
D1203

**Brake Type
& System:**

- Knorr
- SB7 & SN7

Application:

- Neoplan
- Nova
- Prevost
- Setra
- Van Hool



**Kit #
H9911**

FMSI:
D1438

**Brake Type
& System:**

- MERITOR
- PAN 19-1

Application:

- Trailer Axles



**Kit #
H9909**

FMSI:
D1441, D1527

**Brake Type
& System:**

- Haldex
- DB22

Application:

- SAF Axles
- SMB Axles



**Kit #
H9912**

FMSI:
D1441, D1527,
D1583

**Brake Type
& System:**

- BENDEX ESD 225
- HALDEX DB22 MKIV
- HALDEX DB22 LT

Application:

- SAF Axles
- SMB Axles



Heavy Duty Brake Hardware APPLICATIONS



INTERNATIONAL
BRAKE INDUSTRIES, INC.

IBI Kit #	FMSI Reference #	Brake Type & System	OE #	Main Application	WVA Reference #
H9901	D1560	Meritor D-Duco	Meritor# MDP5057 Volvo# 1078439, 20768092, 20918891, 20931343, 20932682, 3095396	Volvo	29125
H9902	D1311 D1370 D1690 D1708 D1323	Meritor EX225H2 EX225H3 EX225L2 ELSA 225-3	Meritor# 3222-F-2476	MCI	29187
H9903	D1310	Meritor D-Elsa2	Meritor# 68324558, 68324957, 68325344, 68325346, 68325901, 68326015 Volvo# 20976509, 21309468, 85107768 Rockwell# 15227419T, 68324558NZP	MAN Van Hool	29131 29156
H9904	D1407	Meritor D-Elsa1 Elsa 225HC	MAN# 81508205091, 81508206044, 81508206046 Meritor# 68325023, 68325166 Seltra# 8 285 388 435	MAN Setra Van Hool	29030
H9905	D1525 D1526	Meritor DX 195 DX225	Meritor# 3222-T-2308, MDP1314, MDP5076, 15224835, 15224835A Rockwell# 15224835T400	Trailer Axles	29124 29155
H9906	D1312	Meritor D Lisa 2x60	Volvo# 3093919, 3093939, 8550611, 20825594, 20850194, 85105485, 8550611	MCI Neoplan Prevost Volvo	29090
H9907	D1369	Knorr SK7 ADB225 ADB22X ADB22X-LT	Mercedes Benz# 004 420 70 20 SAF# 3057008500	SAF Axles	29158
H9908	D1203	Knorr SB7 & SN7	MAN# 81508205099, 81508206032, 81508206056 Neoplan# 0821.340.00, 0821.351.00 SAF# 3057007700, 3057007900, 5317002300 Seltra# 8285000571, 8285515573, 9291037, SMB# M100669	Neoplan Nova Prevost Setra Van Hool	29105, 29087, 29106, 29108, 29109, 29163, 29179, 29201, 29202, 29275
H9909	D1441 D1527	Haldex Misc.	Fruehauf# M910027-03 Haldex# 976003 SAF# 81163, 87407	SAF Axles SMB Axles	29120
H9910	D1518	WABCO PAN 17	MACK# 26-11 12999703VT		29088 29091
H9911	D1438	Meritor PAN 19-1		Trailer Axles	29126 29159
H9912	D1441 D1527 D1583	BENDEX ESD225 HALDEX DB22 MKIV HALDEX DB22 MKIV		SAF Axles SMB Axles	29120 29185 29143 29176